

## INSTALLATION INSTRUCTIONS

DESCRIPTION: Rear A-Arm Guard Kit

PART NUMBER: B4M-F21A0-V0

MODEL: 2021+ Wolverine RMax X2



### **⚠ WARNING**

Please read and understand these instructions completely before installation to avoid possible injury, or damage to the accessory or vehicle.

### **NOTICE:**

This installation requires a torque wrench and should be performed by an authorized Yamaha dealer or other qualified technician.

### **WARRANTY INFORMATION:**

In the United States, see your Yamaha dealer for a copy of the Yamaha Genuine Parts and Accessories Limited Warranty.

### **DEALER OR INSTALLER:**

These instructions contain important information for future reference and *must* be given to the customer.

## PARTS LIST:

No.	Part Number	Description	Qty
--	B4M-F21A0-V0	Rear A-Arm Guard Kit	--
①	*	Left Side Guard	1
②	*	Right Side Guard	1
③	95812-06025	M6x25 Flange Head Bolt	8
④	90201-06802	M6 Washer	8

\* Part supplied with kit only and not available separately.

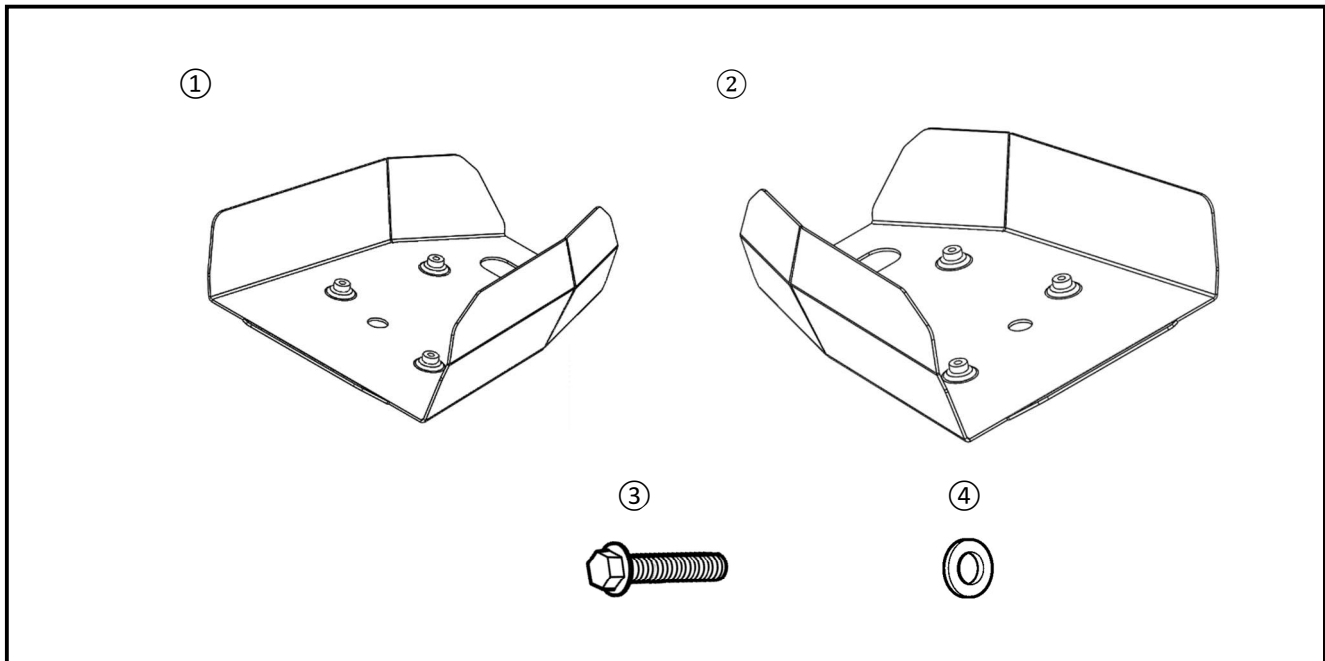

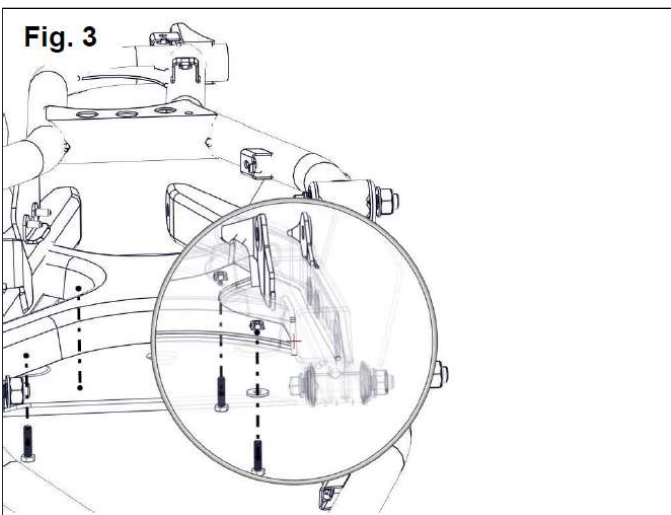
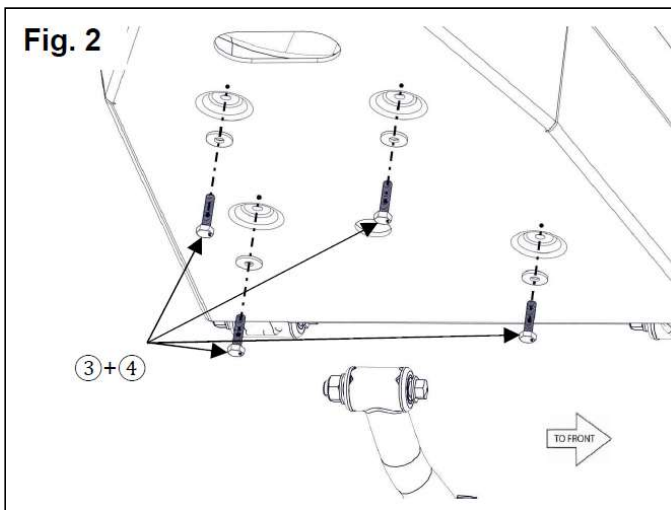
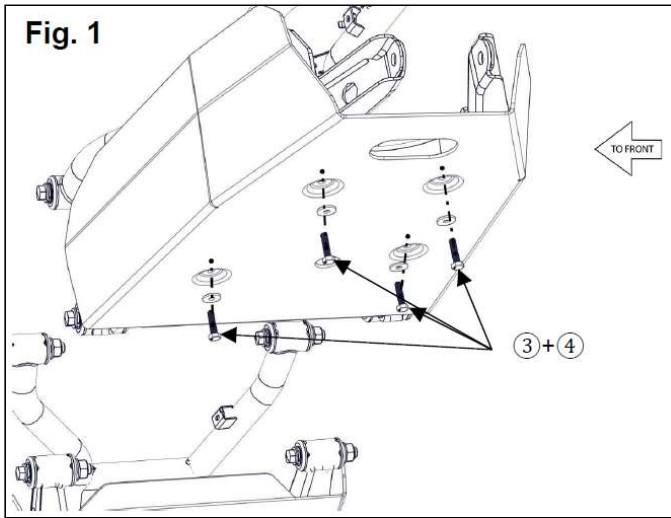

**PREPARATION:**

- Place the vehicle on a secure and level surface.
- Set the parking brake.
- Clean the mount surfaces before starting installation.

**INSTALLATION:**

1. Working from the left rear of the vehicle, test fit the ① Left Side Guard. (Fig. 1).  
Note: The four thru holes should align with the mounting holes in the lower A-Arm.
2. Place a ④ Washer on each of the four ③ M6x25mm Bolts. Insert them from the bottom and up through the ① Left Skid Plate and thread the bolts into the existing threaded holes in the lower A-Arm. Leave the assembly loose. (Fig. 1 and Fig. 3).
3. Follow Step: 1 and 2 for ② Right Side Guard. (Fig. 2 and Fig. 3).
4. Adjust the plate for best fit and torque all the bolts to 8.5 Nm (0.85 kg-m or 6.0 lb-ft).

**MAINTENANCE:**

Periodically check torque and tightness on all hardware. If loose hardware is found, re-torque or re-tighten.

**CARE AND CLEANING:**

Clean metal parts with a clean soft cloth and mild soap and water. Rinse and dry.

**CUSTOMER SERVICE:**

For further information see your Yamaha dealer.

**ESTIMATED TIME TO INSTALL: 0.5 HR**